

HOW TO USE THE ALKON DOT PUSH IN FITTING

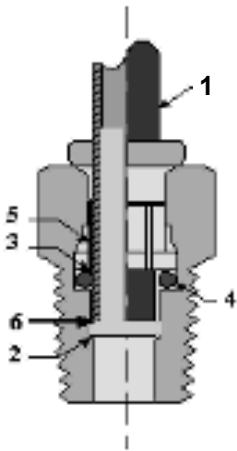

When tubing (1) is inserted into the fitting, it first passes through the brass tube support (2). This, combined with the action of the gripper, insures that the air brake hose assembly will safely exceed the tensile requirements of FMVSS 571.106. The tubing then passes through the gripping teeth (3). The tubing continues beyond the gripping teeth through the inside diameter of the lubricated "O" ring (4), which seals on the outside diameter of the tubing. The gripping teeth grab the tube. Pulling back on the tube only tightens the grip as the insert moves onto the camming surface (5). Pressure through the tube also serves to tighten the grip. The tube bottoms against a positive tube stop (6) in a cavity which keeps tube round to prevent leakage.



To connect tube :

Cut plastic as squarely as possible. Insert tube into fitting until friction is felt as tube slides past the O-ring. Using a slight twisting motion while inserting the tube is often helpful. After this initial friction is felt, continue to push in the tube until it bottoms firmly against the internal tube stop.



To disconnect tube :

With thumb and forefinger, hold down the top of the insert against the fitting body and then, with the other hand, pull out the tubing. No tools are needed.

SPECIFICATIONS

STANDARDS	D.O.T. FMVSS 571.106 Air Brake Performance Requirements.
	SAE J1131, J2494-1 & J2494-3 Air Brake Performance Requirements.
MATERIALS OF CONSTRUCTION	Body (straights), tube supports and grippers : Brass CA360.
	Forged Elbows and Tees : Brass CA377.
	"O" Ring : NBR-269, alternate compounds on request.
TEMPERATURE RANGE	-40 ° F to 212 ° F (other ranges available upon request).
THREADS	NPTF Standard. For other thread standards consult factory.
TUBE "OD" SIZES	5/32", 3/16", 1/4", 3/8", 1/2", 5/8", 3/4" standard.
SWIVEL ELBOWS AND TEES	Designed for alignment purposes only.
FOR USE WITH	J844 Tubing.
CAD DATA	Available upon request.
LIVE SWIVEL	Features self sealed ball bearings with a low friction Buna rotary seal to provide optimum performance and rugged reliability. Max. RPM : 40
PRODUCT FEATURES	
POSITIVE SEAL	Tube support area beyond "O" ring exceeds that of all competitive products. Compensates for bias cut tubing and dramatically reduces trouble shooting time.
SWIVEL & FIXED ELBOWS & TEES	Convenient swivel threaded fittings that allow close center line installation, eliminating orientation problems. Fixed fittings offer the utmost in economy.
THREAD SEALANT	Pre-applied at no charge to all AQ-DOT male threads. Thread Sealant : Loctite 516.
CUSTOM DESIGNS	Alkon offer custom parts on short notice and welcomes these opportunities.

SERIES AQ-DOT - Air Brake Brass Push-In Fittings

AQ18-DOTLS GLADHAND "LIVE SWIVEL" MALE CONNECTOR					
PART NUMBER	TUBE O.D.	PIPE THREAD	A	B	C
AQ18-DOTLS-6X8	3/8	1/2	1.82	1.72	7/8
AQ18-DOTLS-8X8	1/2	1/2	1.96	1.86	7/8



AQ54-DOT 45° MALE ELBOW						
PART NUMBER	TUBE O.D.	PIPE THREAD	A	B	C	D
AQ54-DOT-4X2	1/4	1/8	0.83	0.89	0.99	3/8
AQ54-DOT-4X4	1/4	1/4	0.91	0.89	0.99	3/8
AQ54-DOT-6X2	3/8	1/8	0.75	0.89	0.99	1/2
AQ54-DOT-6X4	3/8	1/4	0.95	0.98	1.08	1/2
AQ54-DOT-6X6	3/8	3/8	0.89	0.98	1.08	1/2
AQ54-DOT-6X8	3/8	1/2	1.13	1.08	1.18	5/8
AQ54-DOT-8X4	1/2	1/4	1.00	1.24	1.34	5/8
AQ54-DOT-8X6	1/2	3/8	1.05	1.10	1.20	5/8
AQ54-DOT-8X8	1/2	1/2	1.20	1.10	1.20	5/8
AQ54-DOT-10X6	5/8	3/8	1.17	1.12	1.22	11/16
AQ54-DOT-10X8	5/8	1/2	1.31	1.12	1.22	11/16
AQ54-DOT-12X8	3/4	1/2	1.36	1.08	1.18	15/16
AQ54-DOT-12X12	3/4	3/4	1.36	1.08	1.18	15/16



AQ54-DOTS SWIVEL 45° MALE ELBOW							
PART NUMBER	TUBE O.D.	PIPE THREAD	A	B	C	D	E
AQ54-DOTS-4X2	1/4	1/8	0.99	0.89	0.99	3/8	7/16
AQ54-DOTS-4X4	1/4	1/4	1.1	0.89	0.99	3/8	9/16
AQ54-DOTS-6X2	3/8	1/8	1.07	0.98	1.08	1/2	7/16
AQ54-DOTS-6X4	3/8	1/4	1.07	0.98	1.08	1/2	9/16
AQ54-DOTS-6X6	3/8	3/8	1.23	0.98	1.08	1/2	11/16
AQ54-DOTS-8X4	1/2	1/4	1.22	1.12	1.22	5/8	9/16
AQ54-DOTS-8X6	1/2	3/8	1.32	1.10	1.20	5/8	11/16
AQ54-DOTS-8X8	1/2	1/2	1.61	1.10	1.20	5/8	7/8
AQ54-DOTS-10X8	5/8	1/2	1.69	1.23	1.33	11/16	7/8
AQ54-DOTS-12X12	3/4	3/4	2.19	1.24	1.32	15/16	1 1/16

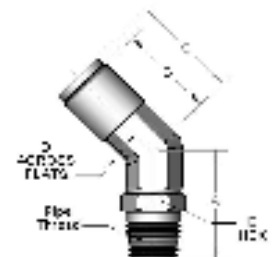

AQ59 NYLON PLUG			
PART NUMBER	A	B	C
AQ59-P-5/32	5/32	1.16	0.32
AQ59-P-4	1/4	1.40	0.43
AQ59-P-6	3/8	1.40	0.55
AQ59-P-8	1/2	1.50	0.7





SERIES AQ-DOT - Air Brake Brass Push-In Fittings

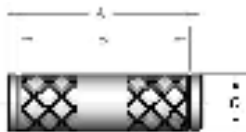

AQ62-DOT UNION CONNECTOR					
PART NUMBER	TUBE O.D.	A	B	C	
AQ62-DOT-5/32	5/32	1.38	1.18	0.37	
AQ62-DOT-4	1/4	1.78	1.58	0.44	
AQ62-DOT-6	3/8	1.84	1.62	0.69	
AQ62-DOT-8	1/2	1.98	1.82	0.81	
AQ62-DOT-10	5/8	2.04	1.84	0.94	
AQ62-DOT-12	3/4	2.20	2.00	1.06	

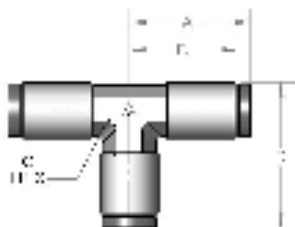

AQ64-DOT UNION TEE						
PART NUMBER	TUBE O.D.	A	B	C	D	
AQ64-DOT-4	1/4	1.02	0.92	3/8	1.26	
AQ64-DOT-6	3/8	1.08	0.98	1/2	1.38	
AQ64-DOT-8	1/2	1.26	1.16	5/8	1.62	
AQ64-DOT-10	5/8	1.29	1.19	11/16	1.72	
AQ64-DOT-12	3/4	1.44	1.34	15/16	1.88	



AQ65-DOT UNION ELBOW						
PART NUMBER	TUBE O.D.	A	B	C	D	
AQ65-DOT-4	1/4	1.01	0.91	3/8	1.24	
AQ65-DOT-6	3/8	1.08	0.98	1/2	1.38	
AQ65-DOT-8	1/2	1.25	1.15	5/8	1.60	

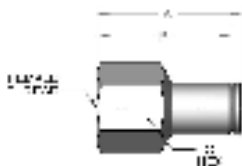

AQ66-DOT FEMALE CONNECTOR						
PART NUMBER	TUBE O.D.	PIPE THREAD	A	B	C	
AQ66-DOT-4X2	1/4	1/8	1.33	1.23	9/16	
AQ66-DOT-4X4	1/4	1/4	1.52	1.42	3/4	
AQ66-DOT-6X4	3/8	1/4	1.4	1.3	3/4	
AQ66-DOT-6X6	3/8	3/8	1.51	1.41	7/8	
AQ66-DOT-8X6	1/2	3/8	1.61	1.51	7/8	
AQ66-DOT-8X8	1/2	1/2	1.81	1.73	1 1/8	

SERIES AQ-DOT - Air Brake Brass Push-In Fittings

AQ688-DOT PRESS-IN CARTRIDGE				
PART NUMBER	TUBE O.D.	A	B	C
AQ688-DOT-5/32	5/32	0.69	0.59	0.32
AQ688-DOT-3	3/16	0.78	0.68	0.41
AQ688-DOT-4	1/4	0.86	0.76	0.41
AQ688-DOT-4X6	1/4	0.86	0.76	0.64
AQ688-DOT-6	3/8	0.86	0.76	0.64
AQ688-DOT-6X8	3/8	1.01	0.91	0.77
AQ688-DOT-8	1/2	1.01	0.91	0.77
AQ688-DOT-10	5/8	1.10	1.00	0.92
AQ688-DOT-12	3/4	1.16	1.06	1.06

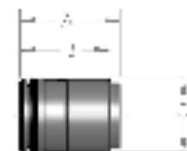

AQ68-DOT MALE CONNECTOR							
PART NUMBER	TUBE O.D.	PIPE THREAD	A	B	C	D	
AQ68-DOT-5/32X1	5/32	1/16	0.77	0.67	3/8	0.09	
AQ68-DOT-5/32X2	5/32	1/8	0.77	0.67	7/16	0.09	
AQ68-DOT-4X1	1/4	1/16	1.02	0.92	7/16	0.14	
AQ68-DOT-4X2	1/4	1/8	1.02	0.92	7/16	0.14	
AQ68-DOT-4X4	1/4	1/4	1.06	0.96	9/16	0.14	
AQ68-DOT-4X6	1/4	3/8	1.12	1.02	11/16	0.14	
AQ68-DOT-6X2	3/8	1/8	1.28	1.18	11/16	0.23	
AQ68-DOT-6X4	3/8	1/4	1.21	1.11	11/16	0.23	
AQ68-DOT-6X6	3/8	3/8	1.12	1.02	11/16	0.23	
AQ68-DOT-6X8	3/8	1/2	1.12	1.02	7/8	0.23	
AQ68-DOT-8X4	1/2	1/4	1.46	1.36	13/16	0.35	
AQ68-DOT-8X6	1/2	3/8	1.4	1.3	13/16	0.37	
AQ68-DOT-8X8	1/2	1/2	1.33	1.23	7/8	0.37	
AQ68-DOT-10X6	5/8	3/8	1.44	1.34	15/16	0.42	
AQ68-DOT-10X8	5/8	1/2	1.6	1.5	15/16	0.42	
AQ68-DOT-12X8	3/4	1/2	1.38	1.28	1 1/16	0.53	
AQ68-DOT-12X12	3/4	3/4	1.38	1.28	1 1/16	0.53	

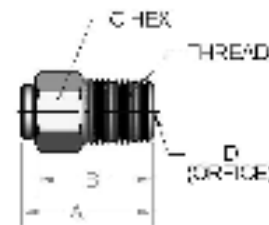

AQ698-DOTS PRESS-IN CARTRIDGE ELBOW							
PART NUMBER	TUBE O.D.	A	B	C	D	E	F
AQ698-DOTS-5/32	5/32	0.79	0.69	3/8	0.95	0.60	0.50
AQ698-DOTS-4	1/4	0.99	0.89	3/8	0.75	0.45	0.56
AQ698-DOTS-6	3/8	1.08	0.98	1/2	1.25	0.65	0.81
AQ698-DOTS-8	1/2	1.26	1.16	5/8	1.31	0.78	0.88
AQ698-DOTS-10	5/8	1.33	1.23	11/16	1.41	0.88	1.06





SERIES AQ-DOT - Air Brake Brass Push-In Fittings

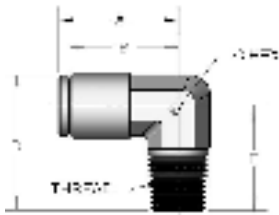

AQ69-DOT MALE ELBOW

PART NUMBER	TUBE O.D.	PIPE THREAD	A	B	C	D	E
AQ69-DOT-5/32X2	5/32	1/8	0.77	0.67	5/16	0.67	0.85
AQ69-DOT-4X2	1/4	1/8	1.01	0.91	3/8	0.75	0.99
AQ69-DOT-4X4	1/4	1/4	1.04	0.94	3/8	0.96	1.20
AQ69-DOT-4X6	1/4	3/8	1.10	1.00	1/2	0.98	1.27
AQ69-DOT-6X2	3/8	1/8	1.08	0.98	1/2	0.80	1.10
AQ69-DOT-6X4	3/8	1/4	1.08	0.98	1/2	0.94	1.25
AQ69-DOT-6X6	3/8	3/8	1.08	0.98	1/2	0.98	1.28
AQ69-DOT-6X8	3/8	1/2	1.14	1.04	5/8	1.19	1.56
AQ69-DOT-8X4	1/2	1/4	1.25	1.15	5/8	1.05	1.45
AQ69-DOT-8X6	1/2	3/8	1.25	1.15	5/8	1.05	1.45
AQ69-DOT-8X8	1/2	1/2	1.26	1.16	5/8	1.26	1.66
AQ69-DOT-10X6	5/8	3/8	1.27	1.17	11/16	1.13	1.59
AQ69-DOT-10X8	5/8	1/2	1.33	1.23	11/16	1.28	1.76
AQ69-DOT-12X8	3/4	1/2	1.32	1.22	15/16	1.36	1.90
AQ69-DOT-12X12	3/4	3/4	1.32	1.22	15/16	1.40	1.96



AQ69-DOTS SWIVEL MALE ELBOW

PART NUMBER	TUBE O.D.	PIPE THREAD	A	B	C	D	E	F
AQ69-DOTS-5/32X2	5/32	1/8	0.79	0.69	3/8	0.91	7/16	1.13
AQ69-DOTS-5/32X4	5/32	1/8	0.79	0.69	9/16	1.02	7/16	1.25
AQ69-DOTS-4X2	1/4	1/8	0.99	0.89	3/8	0.88	7/16	1.13
AQ69-DOTS-4X4	1/4	1/4	0.99	0.89	3/8	1.02	9/16	1.25
AQ69-DOTS-4X6	1/4	3/8	1.08	0.98	1/2	1.14	11/16	1.43
AQ69-DOTS-6X2	3/8	1/8	1.08	0.98	1/2	1.08	7/16	1.38
AQ69-DOTS-6X4	3/8	1/4	1.08	0.98	1/2	1.14	9/16	1.44
AQ69-DOTS-6X6	3/8	3/8	1.08	0.98	1/2	1.19	11/16	1.49
AQ69-DOTS-6X8	3/8	1/2	1.08	0.98	1/2	1.52	7/8	1.82
AQ69-DOTS-8X4	1/2	1/4	1.26	1.16	5/8	1.26	9/16	1.61
AQ69-DOTS-8X6	1/2	3/8	1.26	1.16	5/8	1.34	11/16	1.68
AQ69-DOTS-8X8	1/2	1/2	1.26	1.16	5/8	1.61	7/8	1.96
AQ69-DOTS-10X6	5/8	3/8	1.33	1.23	11/16	1.41	11/16	1.88
AQ69-DOTS-10X8	5/8	1/2	1.33	1.23	11/16	1.71	7/8	2.18
AQ69-DOTS-12X8	3/4	1/2	1.32	1.22	15/16	2.20	1 1/16	2.56
AQ69-DOTS-12X12	3/4	3/4	1.32	1.22	15/16	2.30	1 1/16	2.60

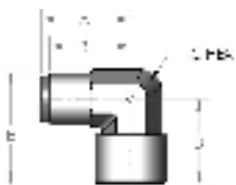

AQ70-DOT FEMALE ELBOW

PART NUMBER	TUBE O.D.	PIPE THREAD	A	B	C	D	E
AQ70-DOT-4X2	1/4	1/8	1.02	0.92	3/8	0.83	1.06
AQ70-DOT-4X4	1/4	1/4	1.12	1.02	1/2	1.02	1.31
AQ70-DOT-4X6	1/4	3/8	1.21	1.11	5/8	0.98	1.35
AQ70-DOT-6X4	3/8	1/4	1.06	0.96	1/2	0.94	1.25
AQ70-DOT-6X6	3/8	3/8	1.08	0.98	5/8	0.91	1.27
AQ70-DOT-8X8	1/2	1/2	1.24	1.14	5/8	1.21	1.57



SERIES AQ-DOT - Air Brake Brass Push-In Fittings

AQ70-DOTS SWIVEL FEMALE ELBOW									
PART NUMBER	TUBE O.D.	PIPE THREAD	A	B	C	D	E	F	
AQ70-DOTS-4X4	1/4	1/4	0.98	0.90	3/8	1.26	3/4	1.50	

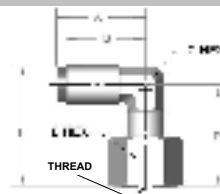

AQ71-DOT MALE RUN TEE									
PART NUMBER	TUBE O.D.	PIPE THREAD	A	B	C	D	E	F	
AQ71-DOT-4X2	1/4	1/8	1.02	0.92	3/8	0.74	1.00	1.24	
AQ71-DOT-4X4	1/4	1/4	1.02	0.92	7/16	0.92	1.00	1.27	
AQ71-DOT-6X4	3/8	1/4	1.08	0.98	1/2	0.98	1.08	1.39	
AQ71-DOT-6X6	3/8	3/8	1.08	0.98	1/2	0.98	1.07	1.37	
AQ71-DOT-8X6	1/2	3/8	1.24	1.14	5/8	1.05	1.24	1.60	

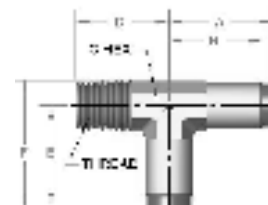

AQ71-DOTS SWIVEL MALE RUN TEE									
PART NUMBER	TUBE O.D.	PIPE THREAD	A	B	C	D	E	F	
AQ71-DOTS-4X2	1/4	1/8	1.00	0.92	3/8	1.05	7/16	1.26	
AQ71-DOTS-4X4	1/4	1/4	1.20	0.92	3/8	1.24	9/16	1.26	
AQ71-DOTS-6X4	3/8	1/4	1.10	1.00	1/2	1.14	9/16	1.45	
AQ71-DOTS-6X6	3/8	3/8	1.08	0.98	1/2	1.18	11/16	1.38	
AQ71-DOTS-8X6	1/2	3/8	1.24	1.14	5/8	1.31	11/16	1.59	
AQ71-DOTS-8X8	1/2	1/2	1.24	1.14	5/8	1.61	7/8	1.59	

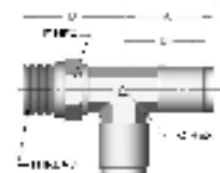

AQ72-DOT MALE RUN TEE									
PART NUMBER	TUBE O.D.	PIPE THREAD	A	B	C	D	E		
AQ72-DOT-4X2	1/4	1/8	1.02	0.92	3/8	0.74	0.98		
AQ72-DOT-4X4	1/4	1/4	1.02	0.92	7/16	0.92	1.17		
AQ72-DOT-6X4	3/8	1/4	1.09	0.99	1/2	1.00	1.30		
AQ72-DOT-6X6	3/8	3/8	1.09	0.99	1/2	0.98	1.29		
AQ72-DOT-8X4	1/2	1/4	1.20	1.10	5/8	1.07	1.43		
AQ72-DOT-8X6	1/2	3/8	1.26	1.16	5/8	1.05	1.41		



AQ72-DOTS SWIVEL MALE BRANCH TEE									
PART NUMBER	TUBE O.D.	PIPE THREAD	A	B	C	D	E	F	
AQ72-DOTS-4X2	1/4	1/8	1.02	0.92	3/8	1.04	7/16	1.28	
AQ72-DOTS-4X4	1/4	1/4	1.02	0.92	3/8	1.16	9/16	1.40	
AQ72-DOTS-6X2	3/8	1/8	1.06	0.96	1/2	1.06	7/16	1.36	
AQ72-DOTS-6X4	3/8	1/4	1.09	0.99	1/2	1.16	9/16	1.46	
AQ72-DOTS-8X4	1/2	1/4	1.26	1.16	5/8	1.26	9/16	1.63	
AQ72-DOTS-8X6	1/2	3/8	1.26	1.16	5/8	1.34	11/16	1.70	
AQ72-DOTS-8X8	1/2	1/2	1.26	1.16	5/8	1.64	7/8	2.00	

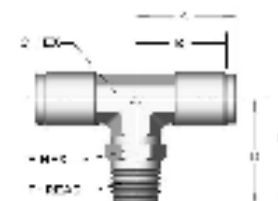

AQ77-DOT FEMALE BRANCH TEE									
PART NUMBER	TUBE O.D.	PIPE THREAD	A	B	C	D	E		
AQ77-DOT-4X2	1/4	1/8	0.95	0.85	7/16	0.75	1.00		
AQ77-DOT-4X4	1/4	1/4	1.08	0.98	1/2	0.96	1.25		
AQ77-DOT-6X4	3/8	1/4	1.06	0.96	1/2	0.98	1.29		
AQ77-DOT-6X6	3/8	3/8	1.40	1.30	11/16	1.30	1.75		

